

## Determining memory requirements

The amount of memory you need depends on the types of documents you print. Your print engine can print most text and graphics at 1,200 dpi FastRes without additional memory.

Add memory to your printer if you:

- commonly print complex graphics.
- use many temporarily downloaded fonts.
- print complex documents.
- print two-sided documents.
- use advanced functions.
- print PostScript documents.

## Installing memory and fonts

### To install DDR memory DIMMs

Use this procedure to install additional memory. Before you begin, print a configuration page (see [To print a configuration page](#)) to find out how much memory is installed in the printer before adding more memory. The table lists the maximum amount of memory allowed for each DIMM slot.

#### Note

On the HP LaserJet 9050 base model, to obtain 512 MB of memory, you need to remove the 64 MB that came with the printer and replace it with 256 MB.







On the HP LaserJet 9050n and the HP LaserJet 9050dn, to obtain 512 MB of memory, you need to remove the 128 MB that came with the printer and replace it with 256 MB.

Slot label on the Configuration page	Slot label on the Formatter board	Description
Slot 1	J1	64 MB or 128 MB depending on model
Slot 2	J2	Empty
Total		64 MB or 128 MB depending on model

#### CAUTION

Static electricity can damage DIMMs. When handling DIMMs, either wear an antistatic wrist strap or frequently touch the surface of the DIMM antistatic package, then touch bare metal on the printer.

### To print a configuration page

- 1 Press .
- 2 Use  or  to scroll to `Information` and press .
- 3 Use  or  to scroll to `Print Configuration` and press .

## To install memory

- 1 If you have not already done so, print a configuration page to find out how much memory is installed in the printer before adding more memory. (Press **22** on the numeric keypad when the printer is idle.)
- 2 Turn the printer off. Disconnect the power cord and any cables.

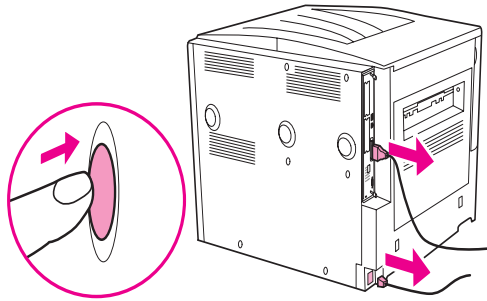

- 3 Loosen the two captive thumb screws on the back of the printer.

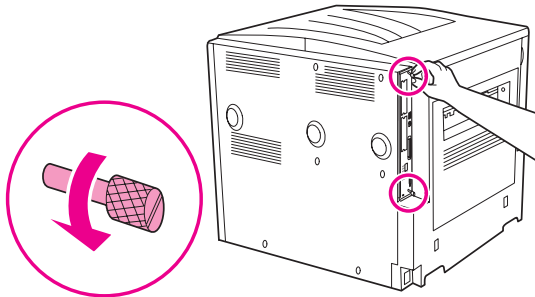

- 4 Grasp the screws and pull the formatter board out of the printer. Place it on a flat, non-conductive surface.

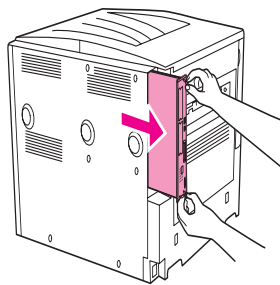

- 5 Remove the DIMM from the antistatic package. Hold the DIMM with fingers against the side edges and thumbs against the back edge. Align the notches on the DIMM with the DIMM slot. (Check that the locks on each side of the DIMM slot are open, or outward.) See [Installing memory and fonts](#) for the maximum amount of memory for each DIMM slot.

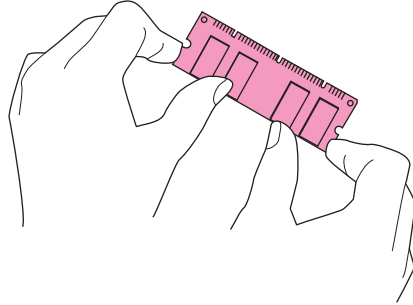

- 6 Press the DIMM straight into the slot (press firmly). Make sure the locks on each side of the DIMM snap inward into place. (To remove a DIMM, the locks must be released.)

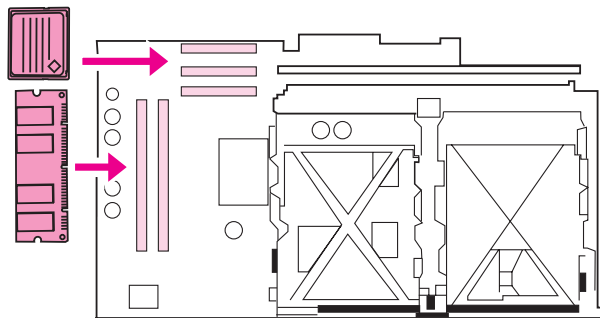

- 7 Slide the formatter board back into the printer and tighten the two screws.

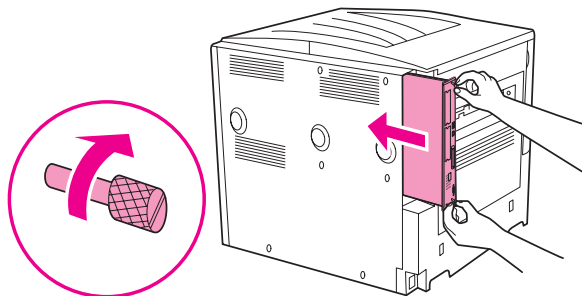

- 8 Plug in the power cord and connect all cables. Turn the printer on.

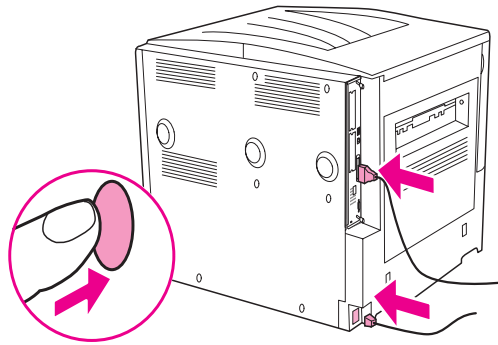

## To install a flash memory card

### CAUTION

Do not insert a flash memory card that is designed for use with a digital camera into the printer. The printer does not support photo printing directly from a flash memory card. If you install a camera-type flash memory card, a message asking if you want to reformat the flash memory card appears on the control-panel display. If you choose to reformat the card, all data on the card will be lost.

- 1 Turn the printer off and disconnect all power and interface cables.

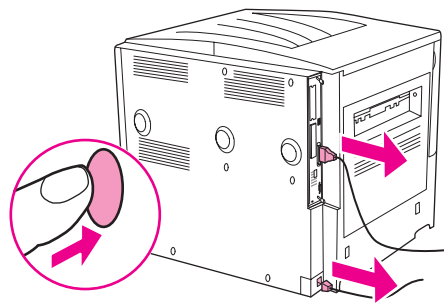

- 2 Loosen the two captive thumb screws on the back of the printer.

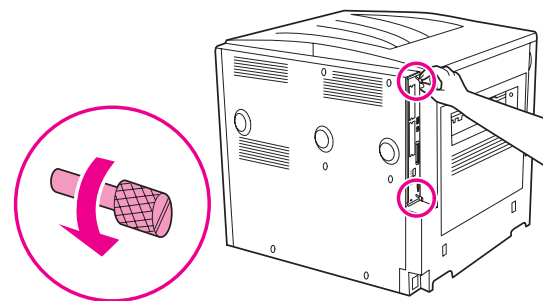

- 3 Grasp the screws and pull the formatter board out of the printer. Place it on a flat, non-conductive surface.

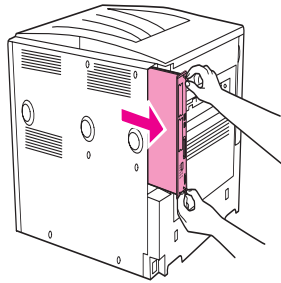

- 4 Remove the compact flash from the antistatic package. Hold the compact flash with fingers against the side edges and thumbs against the back edge. Align the notches on the compact flash with the compact flash slot.

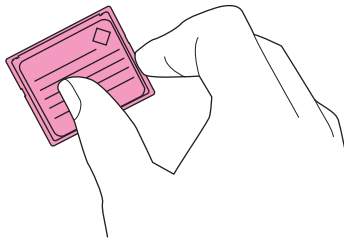

- 5 Press the compact flash straight into the slot.

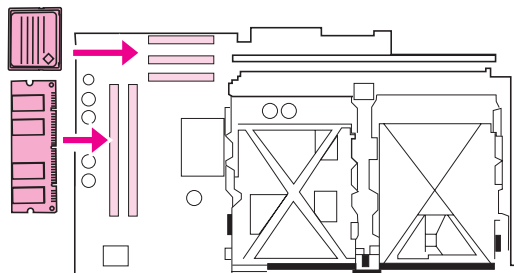

---

**CAUTION**

Do not insert the flash memory card at an angle.

---

**Note**

The first flash memory slot marked "Firmware Slot" is reserved for firmware only. Slots 2 and 3 should be used for all other solutions.

---

- 6 Slide the formatter board back into the printer and tighten the two screws.

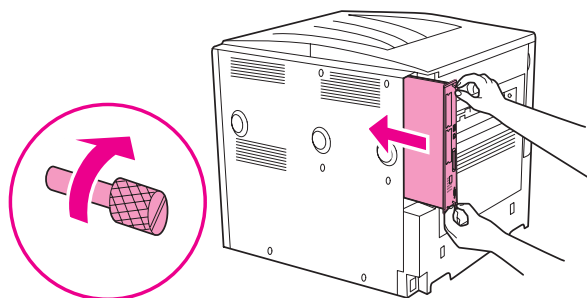

- 7 Plug in the power cord and connect all cables. Turn the printer on.

## Checking memory installation

Follow this procedure to verify that memory is installed correctly:

- 1 Check that **READY** appears on the printer control-panel display when the printer is turned on. If an error message appears, a DIMM might have been incorrectly installed.
- 2 Press **22** on the numeric keypad. The configuration page prints.
- 3 Check the memory section on the configuration page and compare it to the configuration page printed before the DIMM installation. If the amount of memory has not increased, one of the following situations might have occurred:
  - The memory might not be installed correctly. Repeat the installation procedure.
  - The memory might be defective. Try a new DIMM, or try installing the DIMM in a different slot.

---

### Note

---

If you installed a printer language (personality), check the Installed Personalities and Options section on the configuration page. This area should list the new printer language.