

DIMM Installation Guide

Hewlett-Packard 4200 / 4300 Printers:

IMPORTANT: Ensure the printer power is switched OFF, and then disconnect the printer power cord from the AC wall outlet.

1. Unsnap and slide the right-rear panel toward the rear of the printer (Figure 1).
2. Pull open the DIMM access door (Figure 2). The metal door can easily be removed by lifting the door off the hinge slots.

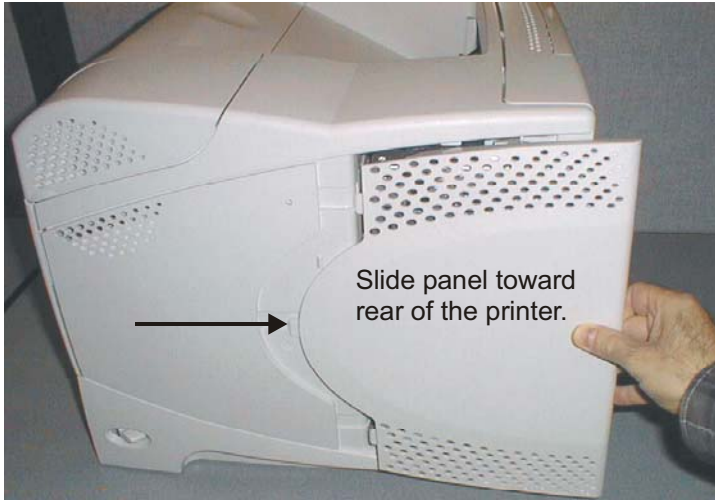

Figure 1

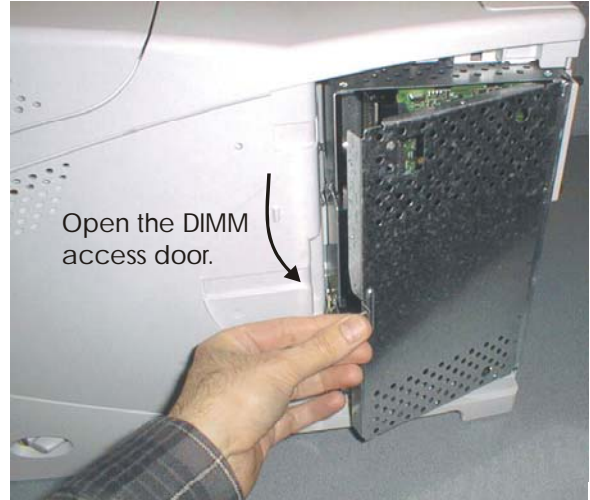

Figure 2

CAUTION: The DIMM is a static-sensitive device and can be permanently damaged if handled improperly. Handle the DIMM by the edges only. Avoid touching the components on the DIMM or the metal contacts along the edge of the DIMM. Before removing the DIMM from the anti-static bag, ground yourself by touching the metal portion of the printer chassis to dissipate static charge.

3. Ensure the retaining clips on the empty DIMM slot are pushed out to the side (Figure 3 and Figure 4) to allow installation of the DIMM.



Figure 3

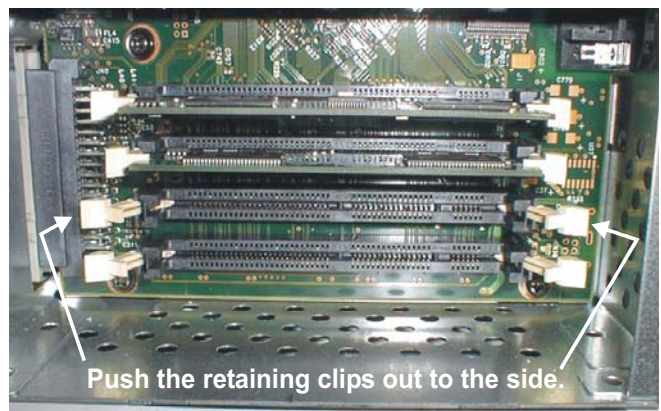
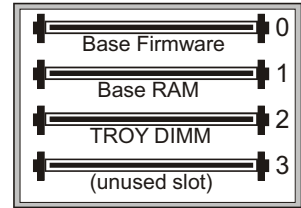

Figure 4

DIMM Installation Guide

4. Ensure the DIMM is oriented correctly (Figure 5), fully insert the DIMM into DIMM slot #2 (Figure 6), and then push firmly on each corner of the DIMM until the DIMM snaps into place. *The retaining clips will close automatically.* Verify the DIMM retaining clips are closed (retaining clips pressed against the DIMM) to ensure the DIMM is properly seated in the DIMM slot. Do not remove or change the slot location of any existing DIMMs.



4200/4300 DIMM Configuration

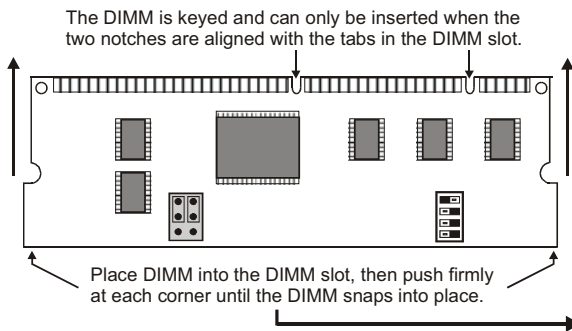

Figure 5

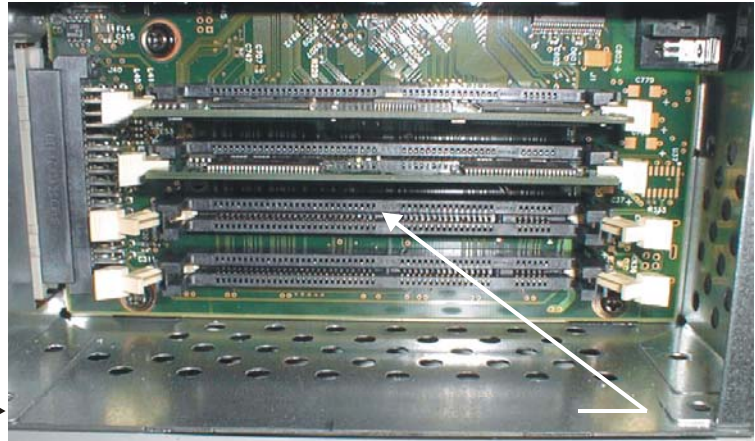

Figure 6

5. Close the DIMM access door, and replace the printer panels.
6. Reconnect the printer power cord and printer data cable.
7. Refer to the HP Quick-Start Guide (provided with your HP DIMM Solution) for instructions on installing the required HP software and support files.

NOTE: If assistance is required for installing the DIMM, please call Altec Technical Support at (800) 997-9921 x 1248.