

Installing Memory

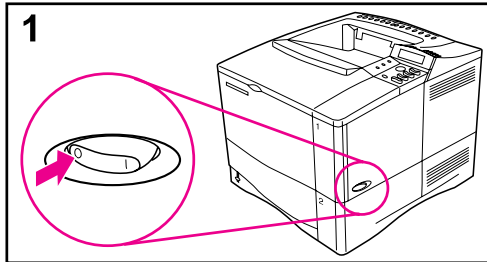

Caution

Static electricity can damage dual in-line memory modules (DIMMs). When handling DIMMs, either wear an antistatic wrist strap or frequently touch the surface of the DIMM's antistatic package, then touch bare metal on the printer.

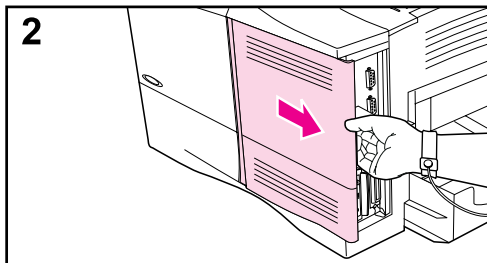

If you have not already done so, print a configuration page to find out how much memory is installed in the printer before adding more memory (page 94).

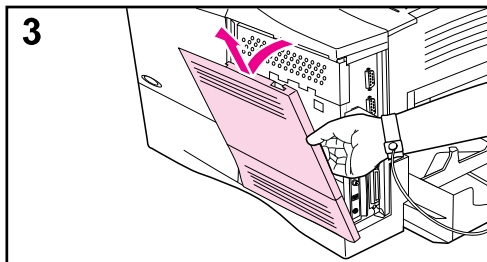

1 Turn the printer off. Rotate the printer for access to its right side. Unplug the power cord and disconnect any cables.

2 Grasp the cover (as illustrated) and pull it firmly toward the rear of the printer until it stops.

3 Remove the cover from the printer.

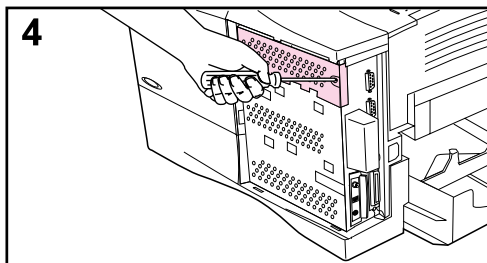

4 Loosen the captive screw holding the DIMM access door with a Phillips #2 screwdriver. Open the door.

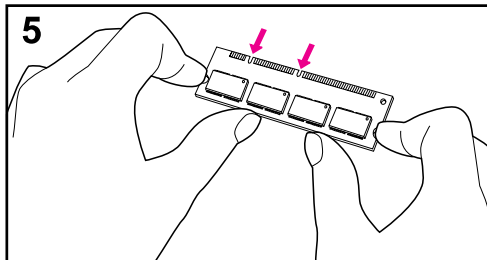

5 Remove the DIMM from the antistatic package. Hold the DIMM with fingers against the side edges and thumbs against the back edge. Align the notches on the DIMM with the DIMM slot. (Check that the locks on each side of the DIMM slot are open, or outward.)

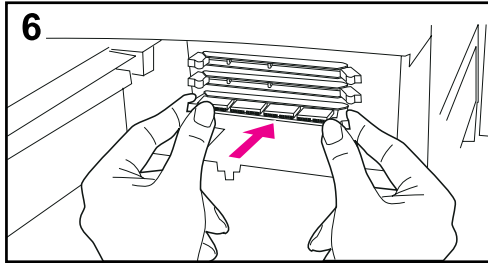

6 Press the DIMM straight into the slot (press firmly). Make sure the locks on each side of the DIMM snap inward into place. (To remove a DIMM, the locks must be released.)

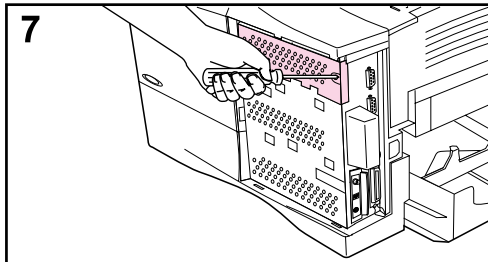

7 Close the DIMM access door and tighten the screw.

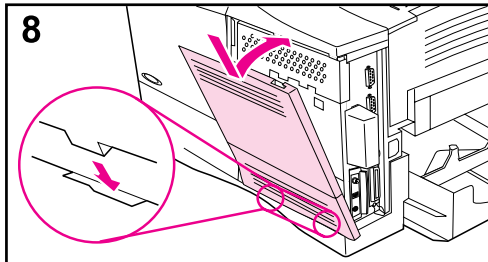

8 Set the bottom of the cover onto the printer. Make sure the bottom tabs on the cover fit into the corresponding slots in the printer. Rotate the cover up towards the printer.

9 Slide the cover toward the front of the printer until it clicks into place. Reattach any interface cables and the power cord, then turn the printer on and test the DIMM. (Go to page C-4.)

